

RETAIL SPACE FOR LEASE

NATURE COAST COMMONS

SWC US HIGHWAY 19 & SPRING HILL DRIVE | SPRING HILL, FL 34607

SUITES AVAILABLE FROM 1,160 TO 15,580 SF

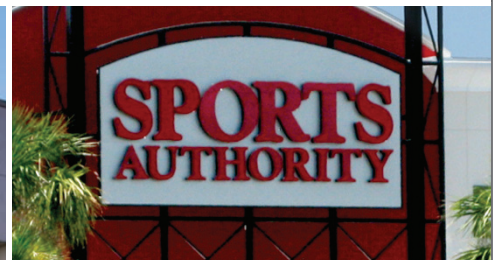

PROPERTY HIGHLIGHTS

- 227,000*-square-foot power center anchored by Sports Authority, Best Buy, Ross Dress for Less, Office Depot and PetSmart
- Excellent visibility from US Highway 19
- Nearby retailers include JCPenney, Walmart and Publix
- Located in a densely populated area with more than 190,000 people within a 10-mile radius**

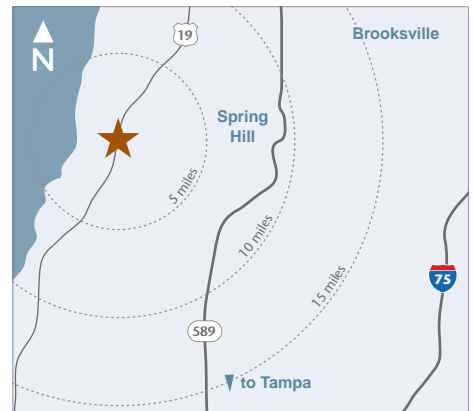

*Approximate **Source: Claritas, 2012

NORTH AMERICAN PROPERTIES



NORTH AMERICAN PROPERTIES
7500 COLLEGE PARKWAY
FT. MYERS, FL 33907 | 239.278.1121
WWW.NAPROPERTIES.COM

CRAIG KOPKO
239.938.3359
CRAIG.KOPKO@NAPROPERTIES.COM

NATURE COAST COMMONS



PROPERTY LINEUP

TENANT	SQUARE FEET	TENANT	SQUARE FEET
AVAILABLE	15,502	PANERA BREAD	4,730
AVAILABLE	10,200	PETSMART	20,069
AVAILABLE	5,998	PIER1 IMPORTS	8,303
AVAILABLE	5,393	ROSS	27,783
AVAILABLE	5,215	SALLY BEAUTY SUPPLY	1,400
AVAILABLE	1,161	SCOTTRADE	1,708
BEST BUY	30,183	SPA ONE NAILS	1,174
DOLLAR TREE	9,000	SPORTS AUTHORITY	42,046
GNC	1,522	VERIZON	1,500
MATTRESS GIANT	4,046	WELLS FARGO	5,733
OFFICE DEPOT	20,898	TOTAL:	227,160

ANCHORS



Office DEPOT
What you need. What you need to know.



MARKET DATA

DEMOGRAPHICS**	1 MILE	3 MILES	5 MILES
2012 POPULATION:	3,324	25,972	56,328
2012 AVG. HOUSEHOLD INCOME:	\$35,388	\$43,018	\$43,288

TRAFFIC COUNTS	VPD
US 19	33,000

*NOT A PART. **Source: Claritas, 2012

Cole is not affiliated or associated with, is not endorsed by, does not endorse, and is not sponsored by or a sponsor of the tenants or of their products or services pictured or mentioned. The names, logos and all related product and service names, design marks, and slogans are the trademarks or service marks of their respective companies. We obtained the information above from sources we believe to be reliable. However, we have not verified its accuracy and make no guarantee, warranty or representation about it. It is submitted subject to the possibility of errors, omissions, change of price, rental or other conditions, prior sale, lease or financing, or withdrawal without notice.



WWW.COLECAPITAL.COM | 877.800.COLE (2653)
© 2012 Cole Capital Advisors, Inc. All Rights Reserved.

FOR MORE INFORMATION »

